

DRUM GRIPPER TYPE FK



FK-II

	Max. no. of 200 l drums	Load capacity in kg	Dimensions in mm (l x w x h)	Weight in kg (painted/galv.)
FK-I	1	500	1285 x 600 x 165	67 / 74
FK-II	2	1000	1320 x 1230 x 165	99 / 109

The safe way to pick up and transport 200 litre steel bung hole drums, steel drums with a lid and rolling hoop drums

- available for 1 or 2 drums
- opens automatically when set down
- can be secured to prevent slipping

Fork sleeve inside dimensions in mm

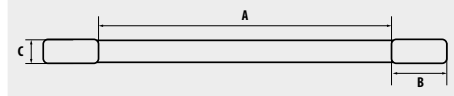

	A	B	C
FK-I / FK-II	250	170	75

DRUM JACK TYPE FH



FH-II 220

	Max. no. of 120 / 220 l drums	Load capacity in kg	Dimensions in mm (l x w x h)	Weight in kg (painted/galv.)
FH-I 120	1 / -	300	1330 x 505 x 380	49 / 53
FH-I 220	- / 1	360	1380 x 600 x 480	54 / 58
FH-II 120	2 / -	600	1330 x 980 x 385	67 / 72
FH-II 220	- / 2	720	1380 x 1160 x 485	76 / 82

Ideal for handling 120, 150 or 220 litre plastic drums

- the gripping brackets guarantee safety during transport
- can be used to stack plastic drums with a lid without using pallets

Fork sleeve inside dimensions in mm

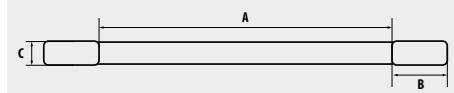

	A	B	C
FH-I 120	155	170	75
FH-I 220	250	170	75
FH-II 120	250	170	75
FH-II 220	250	170	75

DRUM TURNER TYPE FW

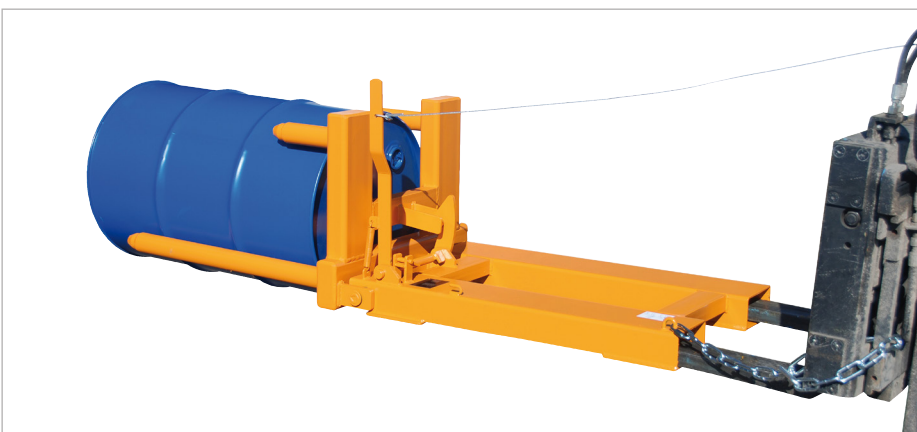

FW-I

	Max. no. of 200 l drums	Load capacity in kg	Dimensions in mm (l x w x h)	Weight in kg (painted/galv.)
FW-I	1	300	1875 x 700 x 545	108 / 116
FW-II	2	600	1875 x 1320 x 545	150 / 162

Upright or set down 200 litre steel bung hole drums and rolling hoop drums - turn drums from a horizontal position to a vertical position and vice versa

- suitable for charging drum shelves etc.

Fork sleeve inside dimensions in mm

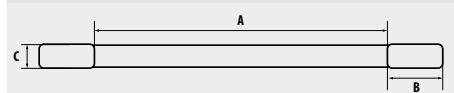

	A	B	C
FW-I	260	170	75
FW-II	590	170	75

Finish:

RAL 2000

hot-dip galvanized